

# SHARPS Sporting Rifle

## Care and Loading Instructions

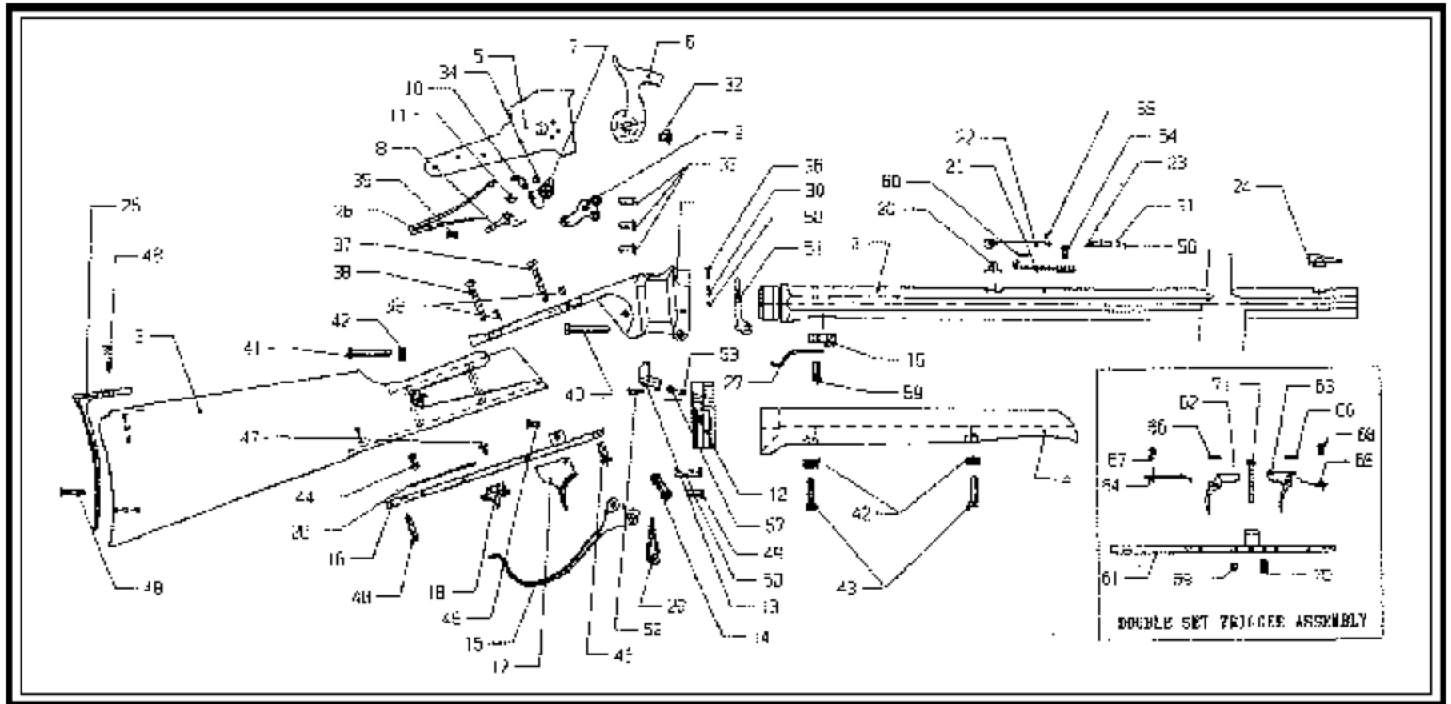

1	ARM11	Frame	31	ARM131	Rear Sight Slide Spring	54	ARM154	Rear Sight Spring Screw
2	ARM12	Barrel	32	ARM132	Hammer Screw	55	ARM155	Rear Sight Slide Retainer Screw
3	ARM13	Stock	33	ARM133	Tumbler Screw	56	ARM156	Friction Ball (Rear Sight Slide)
4	ARM14	Forend	34	ARM134	Stirrup Screw	57	ARM157	Firing Pin
5	ARM15	Side Plate	35	ARM135	Main Spring Retainer Screw	58	ARM158	Lever Pin Plunger
6	ARM16	Hammer	36	ARM136	Lever Pin Plunger Screw	59	ARM159	Lever Action Spring Screw
7	ARM17	Tumbler	37	ARM137	Front Tang Screw	60	ARM160	R. Sight Leaf Pin To Right Sight Spring
8	ARM18	Sear	38	ARM138	Rear Tang Screw	61	ARM161	Double Set Trigger Guard Plate
9	ARM19	Bridle	39	ARM139	Creedmore Sight Base Holes	62	ARM162	Rear Trigger
10	ARM110	Stirrup	40	ARM140	Side Plate Front Screw	63	ARM163	Front Trigger
11	ARM111	Fly	41	ARM141	Side Plate Rear Screw	64	ARM164	Rear Trigger Spring
12	ARM112	Breech Block	42	ARM142	Side Plate Screw Washer	65	ARM165	Front Trigger Spring
13	ARM113	Firing Pin Pusher	43	ARM143	Forend Screw	66	ARM166	Trigger Pin
14	ARM114	Link	44	ARM144	Trigger Lock Spring Screw	67	ARM167	Rear Trigger Spring Screw
15	ARM115	Lever	45	ARM145	Trigger Screw	68	ARM168	Front Trigger Spring Screw
16	ARM116	Trigger Guard Plate	46	ARM146	Front Guard Screw	69	ARM169	Rear Trigger Regulating Screw
17	ARM117	Trigger	47	ARM147	Trigger Lock Screw	70	ARM170	Regulating Screw
18	ARM118	Trigger Lock	48	ARM148	Rear Guard Screw/Butt Plate	71	ARM171	Front Tang Screw
19	ARM119	Barrel Lug	49	ARM149	Link To Lever Screw			
20	ARM120	Rear Sight Base	50	ARM150	Link To Breech Block Screw			
21	ARM121	Rear Sight Spring	51	ARM151	Extractor			
22	ARM122	Rear Sight Leaf	52	ARM152	Firing Pin Screw			
23	ARM123	Rear Sight Slide	53	ARM153	Firing Pin Spring			
24	ARM124	Front Sight						
25	ARM125	Butt Plate						
26	ARM126	Main Spring						
27	ARM127	Lever Spring						
28	ARM128	Trigger Lock Spring						
29	ARM129	Receiver Lever Pin						
30	ARM130	Lever Pin Plunger Spring						

## ***INITIAL CARE AND CLEANING***

1. Before handling this or any other firearm, always make sure the firearm is unloaded and pointed in a safe direction.
2. Using a quality gun solvent, remove all excess factory lubricant. Field stripping the firearm will facilitate this process. (See Field Stripping). Relubricate all moving contact points with a quality “spray type” gun lubricant.
3. Thoroughly clean the bore, and remove all excess solvent with clean, dry patches, replacing them as often as necessary until they come out clean and dry.
  - a. A slight film of gun oil should be left in the barrel during long periods of storage, however, the cleaning procedure **MUST** be repeated before shooting the firearm. **The barrel must always be clean and dry before shooting.**

## ***FIELD STRIPPING***

1. After making sure the gun is unloaded, and with the muzzle pointed in a safe direction, field strip the gun.
  - a. With the action **CLOSED**, place the hammer in the half-cock position You will notice a tiny plunger pin located on the right side of the frame.
  - b. The lever hinge pin is located on the lower front of the frame on the right hand side of the rifle. While pushing in on the tiny plunger pin, rotate the arm of the lever hinge pin forward past the plunger pin, approximately 180 degrees from its original position. Turn the rifle upside down. While rotating forward and backward a few degrees, and pulling outward, remove the lever hinge pin. After the lever hinge pin has been removed, slide the lever and the breech block up and out of the rifle.
  - c. You have now field stripped the rifle. Further disassembly should be attempted only by a competent gunsmith.
  - d. Reverse the above procedure for reassembly.

## ***SAFETY***

1. We strongly recommend you practice the procedure of placing the rifle on safe **before** attempting to load and fire the rifle.
2. To place the rifle on safe, slowly drop the hammer to the half-cock position. We strongly recommend not loading the rifle until you are in the hunting field, or on the target range and you are ready to shoot safely.

## ***LOADING AND FIRING***

1. Use only factory loaded ammunition, or black powder hand loaded. Ammunition used should not exceed 25,000 c.u.p.
2. To load the rifle, first point the muzzle downrange in a safe direction. Place the rifle on safe, by placing the hammer in the half-cock position. Extend the lever downward, fully opening the breech. Carefully insert one cartridge of correct caliber completely into the breech and close the action. You are now ready to fire the rifle.
3. To fire, point the rifle downrange toward your target and fully cock the hammer. While pointing at your target, slowly pull on the rear trigger until it sets. While aiming at your target, slowly squeeze the front trigger and your rifle will fire.
  - a. If your rifle is equipped with an adjustable set trigger assembly. Screw the trigger adjusting screw inward or outward until the desired trigger pressure is obtained. Always adjust the set triggers with an unloaded rifle !!! Use an empty case in the chamber when setting, so the firing pin has something to contact when pulling the trigger. If more than 5 shots are required to set the triggers, use a different empty case.

## **SIGHTING**

1. Your Sharps Rifle is equipped with an adjustable rear sight with a provision for windage and elevation. Sighting adjustments should be made with the front sight, which, for the models provided with dove tail, is adjustable for windage. With a brass hammer, the front sight can be moved left or right, depending on which direction your rifle happens to be shooting. Move the front sight in the direction you are shooting. If you are shooting to the left, move your front sight left; if it shoots right, move the front sight right.